

# PRODUCTS





FILO MURO/ doors flush with the wall



FILO Rossore/ doors flush with casing



TELAIO/ doors with raised casing



OMBRA/ floating jamb with shadow reveal





## Filo muro/ frameless, flush with the wall

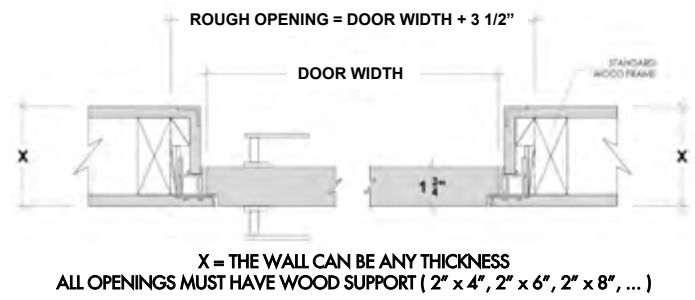

## Telaio/ doors with raised casing

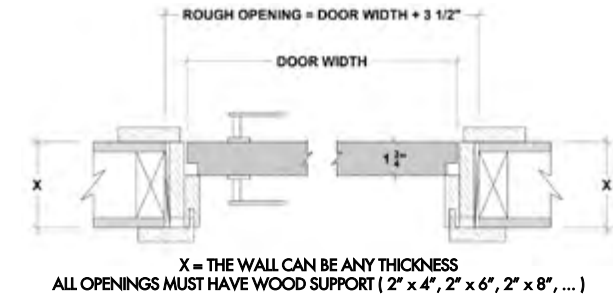

Standard Installation      Flush with Drywall Installation



## Filo rossore/ doors flush with casing

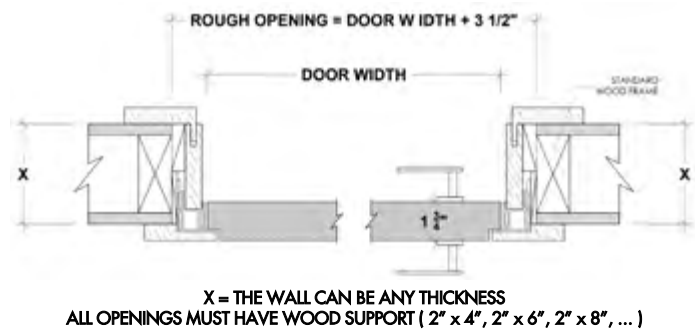

Standard Installation      Flush with Drywall Installation



## Ombra/ floating jamb with shadow reveal

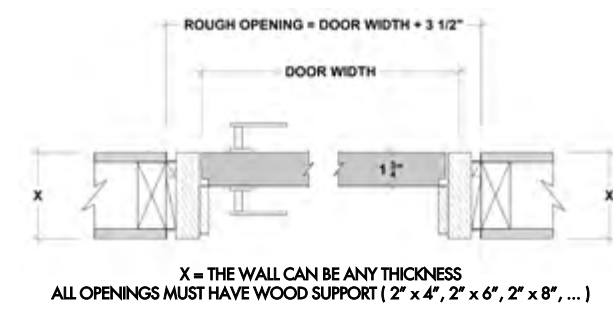

Standard Installation      Jamb Proud of the wall Installation





# Filo muro/ frameless, flush with the wall

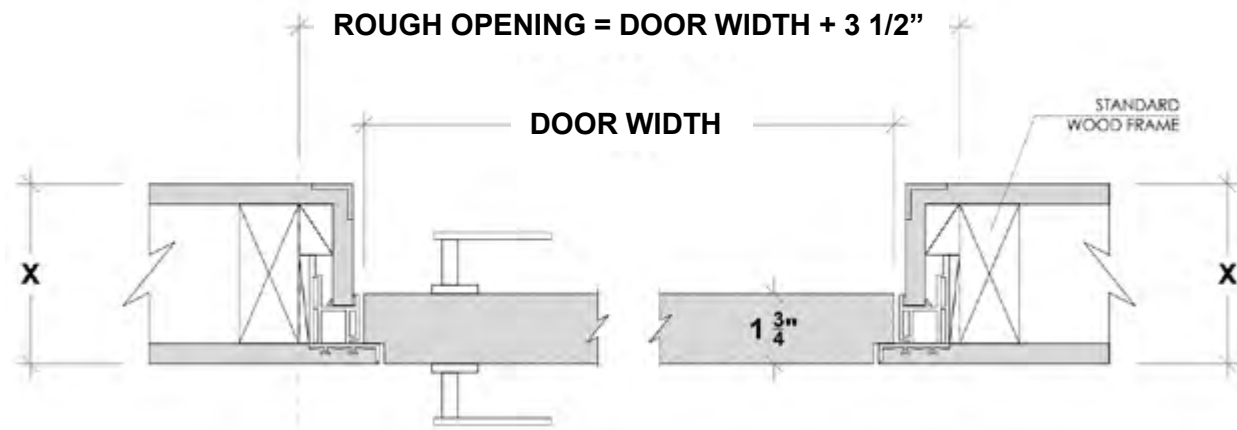

X = THE WALL CAN BE ANY THICKNESS  
ALL OPENINGS MUST HAVE WOOD SUPPORT ( 2" x 4", 2" x 6", 2" x 8", ... )

## FILO MURO/ SPECIFICATIONS:



FILO MURO/  
SWING DOORS PDF



FILO MURO/  
POCKET DOORS PDF



FILO MURO/  
EURO DOORS PDF



FILO MURO/  
BIFOLD DOORS PDF



FILO MURO/  
BYPASS DOORS PDF



FILO MURO/  
PIVOT DOORS PDF



FILO MURO/  
GHOST DOORS PDF



FILO MURO/  
BARN DOORS PDF



FILO MURO/  
REGLET PDF



FILO MURO/  
FINISHING INSTRUCTIONS PDF



Filo muro/ Natur, floor to ceiling application





DETAILS

Filo rossore/ doors flush with casing

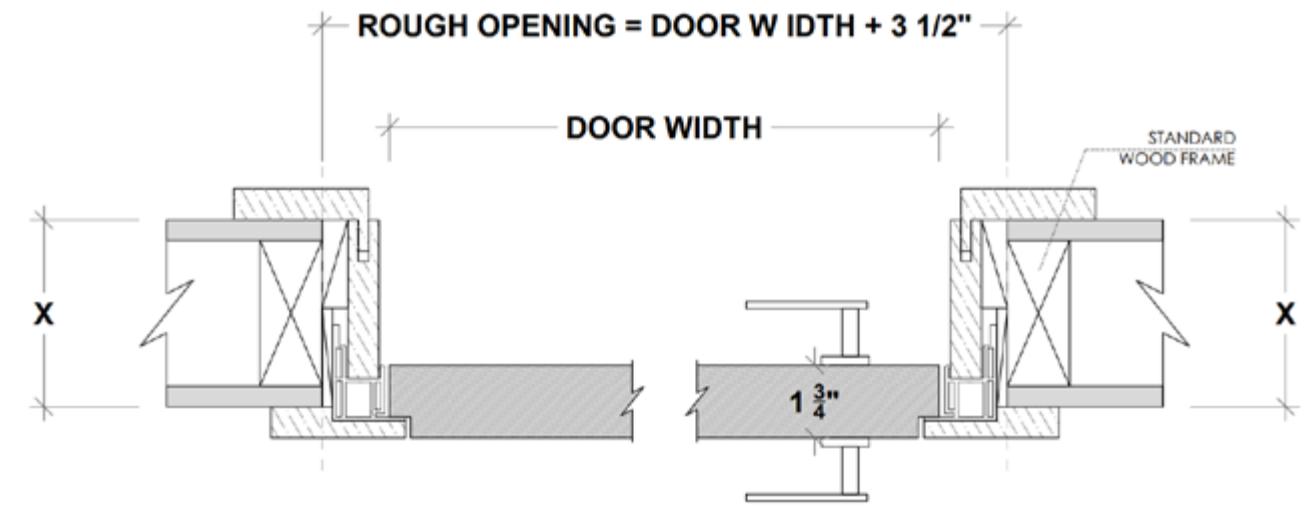

X = THE WALL CAN BE ANY THICKNESS  
ALL OPENINGS MUST HAVE WOOD SUPPORT ( 2" x 4", 2" x 6", 2" x 8", ... )

FILO/ SPECIFICATIONS:



FILO/  
SWING DOORS PDF



FILO/  
POCKET DOORS PDF



FILO/  
EURO DOORS PDF



FILO/  
BIFOLD DOORS PDF



FILO/  
BYPASS DOORS PDF



FILO/  
PIVOT DOORS PDF





# Telaio/ doors with raised casing

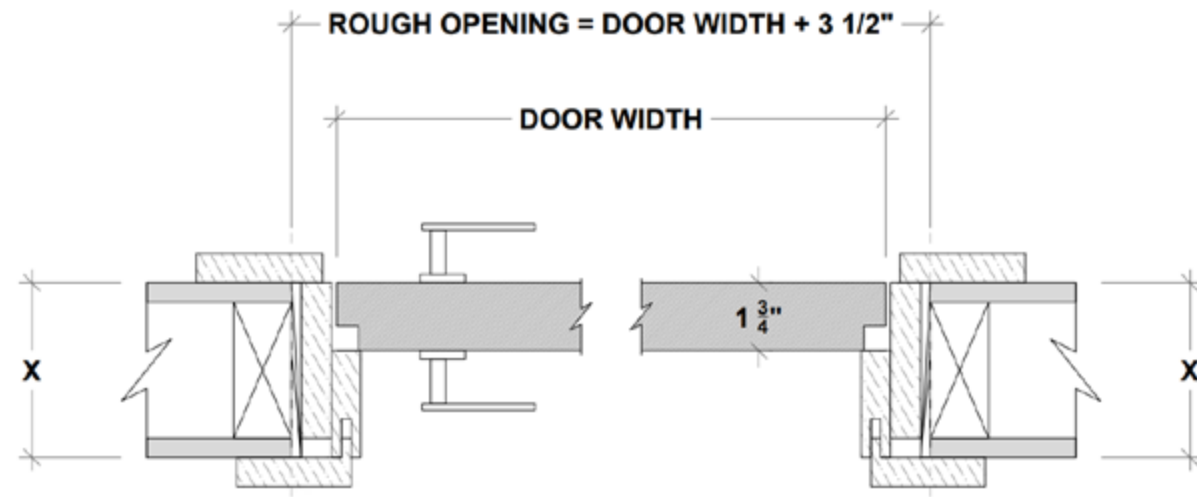

X = THE WALL CAN BE ANY THICKNESS  
ALL OPENINGS MUST HAVE WOOD SUPPORT ( 2" x 4", 2" x 6", 2" x 8", ... )

## TELAIO/ SPECIFICATIONS:



TELAIO/  
SWING DOORS PDF



TELAIO/  
POCKET DOORS PDF



TELAIO/  
EURO DOORS PDF



TELAIO/  
BIFOLD DOORS PDF



TELAIO/  
BYPASS DOORS PDF



TELAIO/  
PIVOT DOORS PDF



Telaio/ Stained white oak, design: Shaker 4







DETAILS

Ombra/ floating jamb with shadow reveal

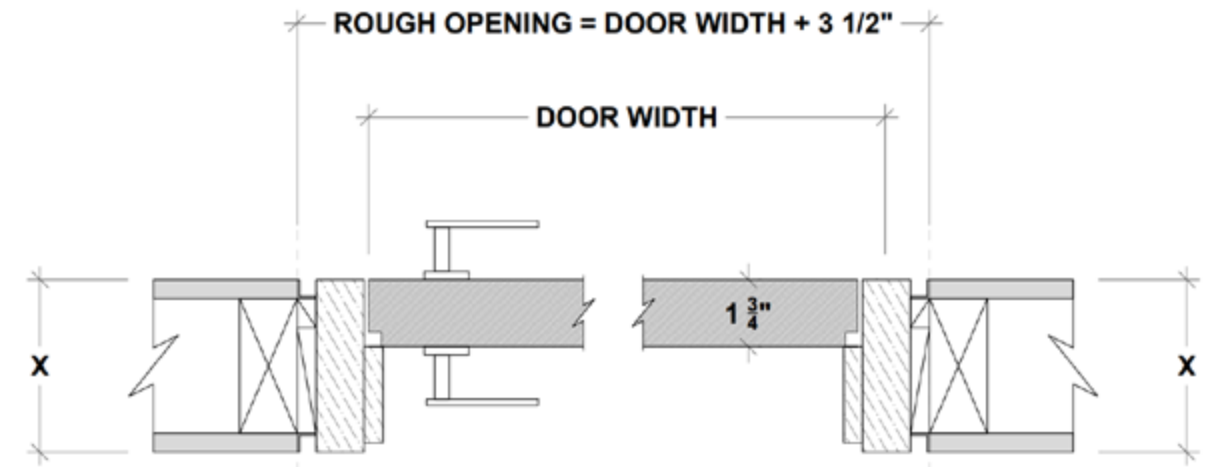

X = THE WALL CAN BE ANY THICKNESS  
ALL OPENINGS MUST HAVE WOOD SUPPORT ( 2" x 4", 2" x 6", 2" x 8", ... )

OMBRA/ SPECIFICATIONS:



OMBRA/  
SWING DOORS PDF



OMBRA/  
POCKET DOORS PDF



OMBRA/  
EURO DOORS PDF



OMBRA/  
BIFOLD DOORS PDF



OMBRA/  
BYPASS DOORS PDF



OMBRA/  
PIVOT DOORS PDF





# Panel/ doors and paneling applications



Outswing Profile

Inswing Profile



## PANEL/ SPECIFICATIONS:



PANEL/  
SWING DOORS PDF



PANEL/  
EURO DOORS PDF



PANEL/  
BIFOLD DOORS PDF



PANEL/  
PIVOT DOORS PDF







## THE DAYORIS ADVANTAGE

Imported and Domestic fabrication.

Up to 6' wide and 12' tall.

A complete door package.  
(finished door, frame, complete hardware set)

Custom built to specifications.

Expert support staff.

Floor to ceiling application.

Complete vertical process.  
(design / manufacturing / installation)

## THE PROCESS

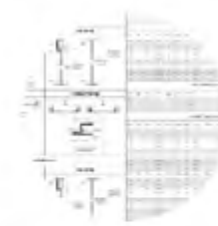

### 1. FLOOR PLAN / DOOR SCHEDULE

Client sends basic information  
of the project, floor plan,  
specifications.



### 2. PROPOSAL SENT WITHIN 24 / 48 HOURS

Once we receive project details,  
our estimators work on the  
proposal within 48 hours.



### 3. PROPOSAL APPROVED

Dayoris received a formal  
approval by mail. Contact  
information is in the proposal.



### 4. PROJECT PLANNER ASSIGNED

Email intro and set up a Zoom  
meeting, details, rough  
openings and specs.



### 5. MASTERSHEET ALIGNMENT

Creation of a Mastersheet with  
all project specifications, details.



### 6. DOOR PRODUCTION

Once approved, door  
production begins.



### 7. SHIPPING SERVICE

Shipping arranged throughout  
the US. and abroad.



### 8. INSTALLATION PROCESS

We offer installation and  
technical support.





THE DAYORIS DIFFERENCE

SOLID CORE

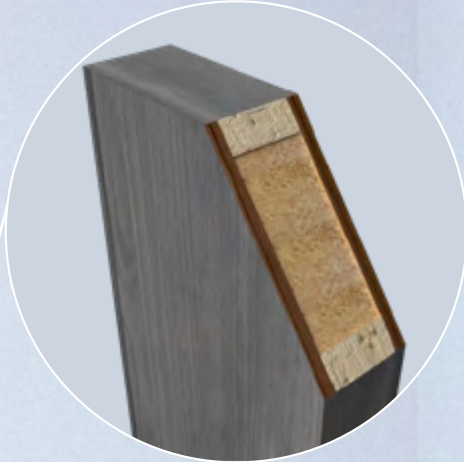

MAGNETIC LOCKSET



CONCEALED HINGE



PRIME  
LACQUER  
LAMINATED  
WOOD VENEER







ARTISANAL



# Door Profiles

Premium Interior Door Solutions

All of our doors are tailor-made to client specifications, allowing for virtually any size, style, or finish.

### Technical Specifications:

- Door Slab size up to 6'x12' (Custom Systems available for wider applications)
- Primed, Laminated, Lacquer and Wood Veneer finishes.
- Frames: Frameless profile, wood and metal.
- Thickness from 1" to 1 3/4"
- Standard and Floor to ceiling applications.

Swing/ Pivot/ Pocket/ Bypass/ Euro System 1" Doors/ Euro Bifold 1" Doors/

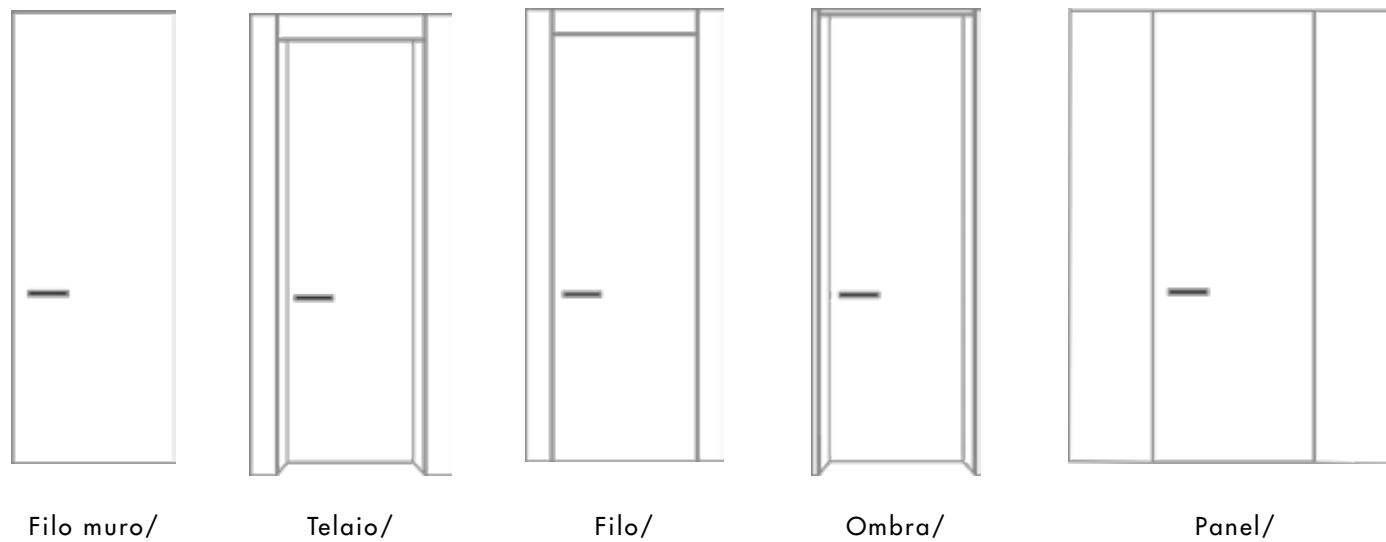

# Designs

Reveal Designs (available in 1/8" grooves or 1/2" aluminum inserts)

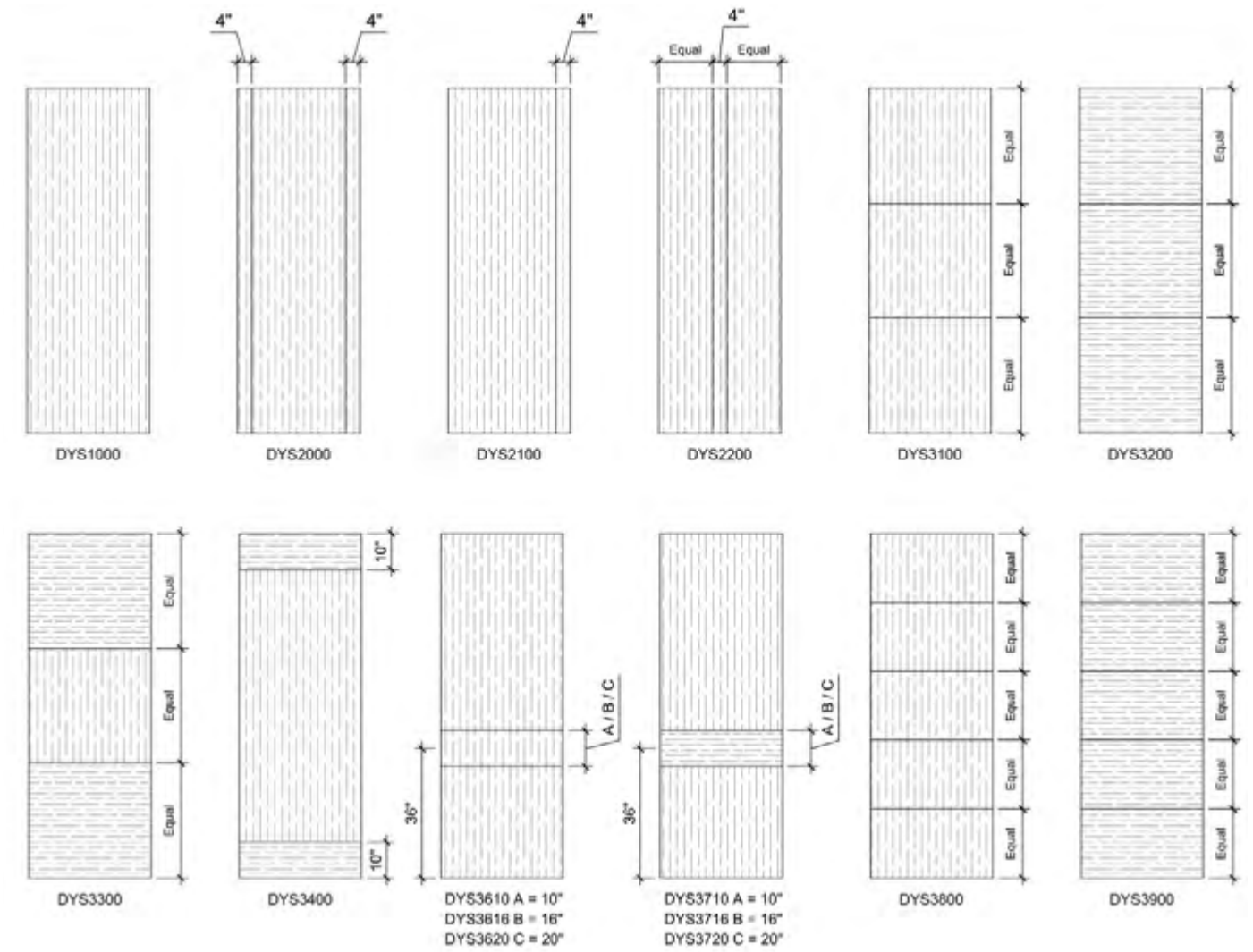

Glass Designs (available in clear or laminated)

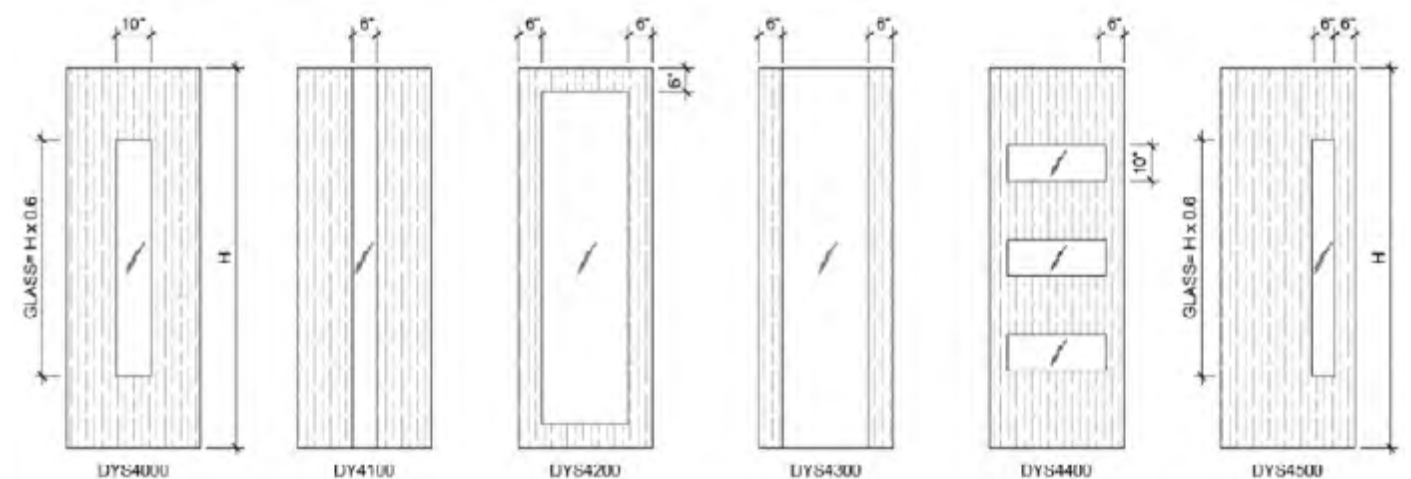





### Shaker Designs

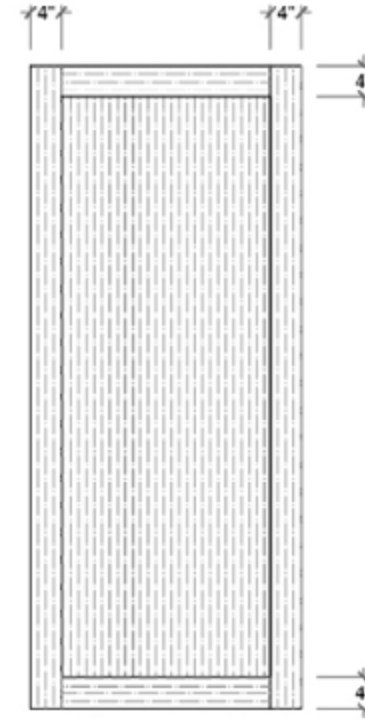

Shaker 1

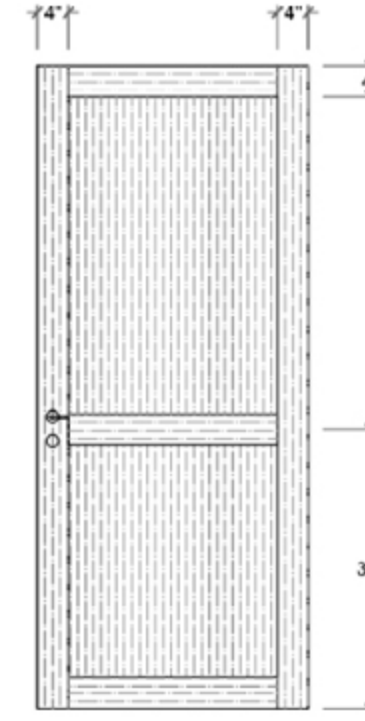

Shaker 2

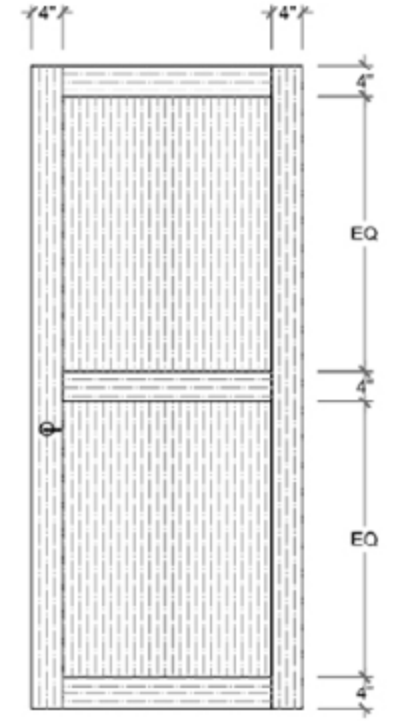

Shaker 3

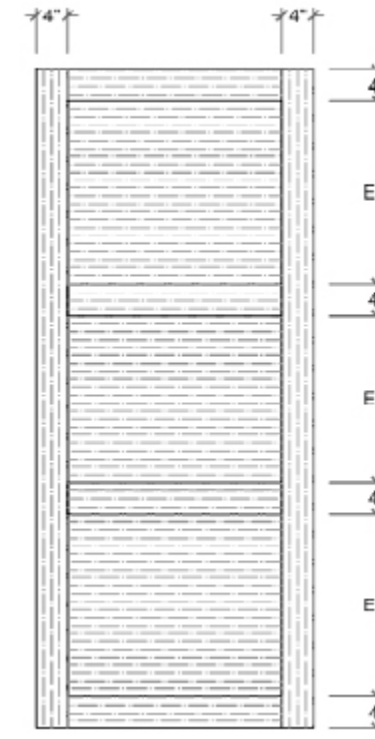

Shaker 4

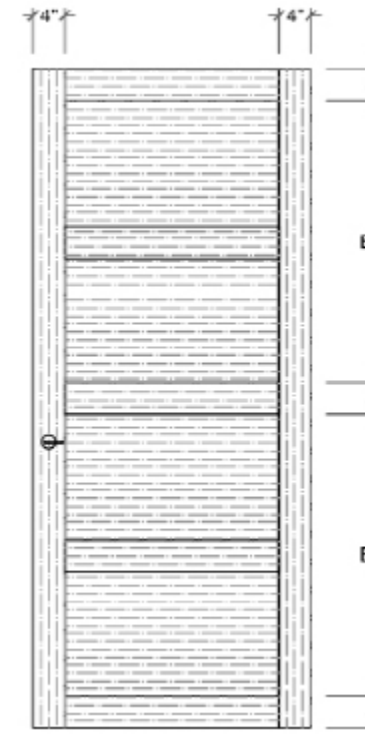

Shaker 5

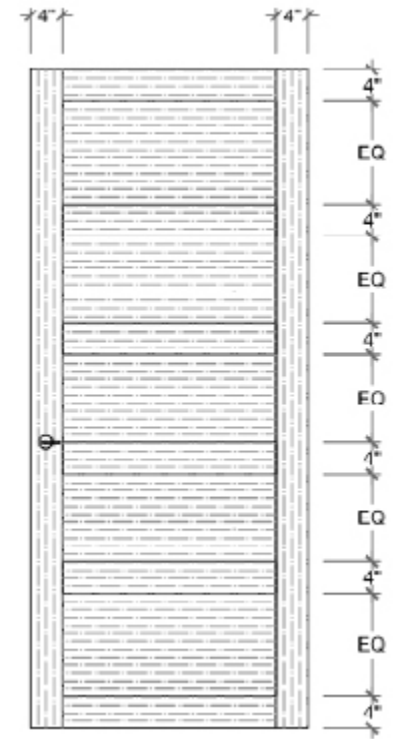

Shaker 6





Swing

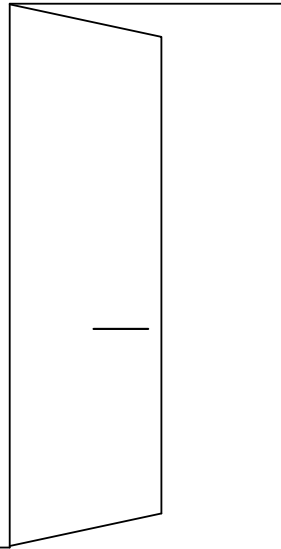

Pivot

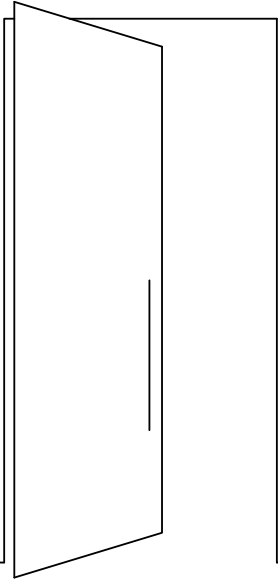

Pocket

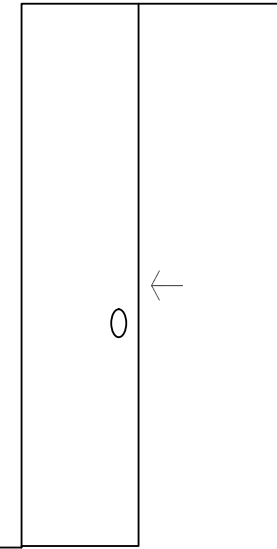

Bypass

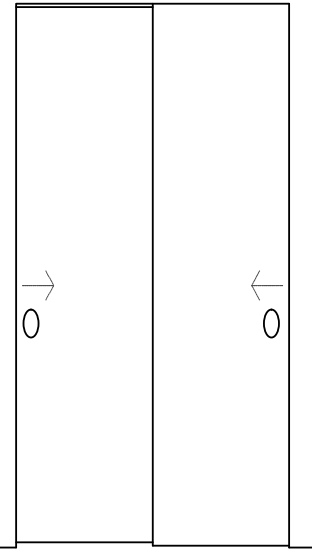

Euro

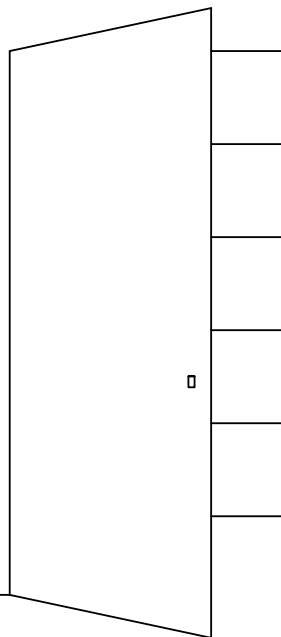

Euro Bifold

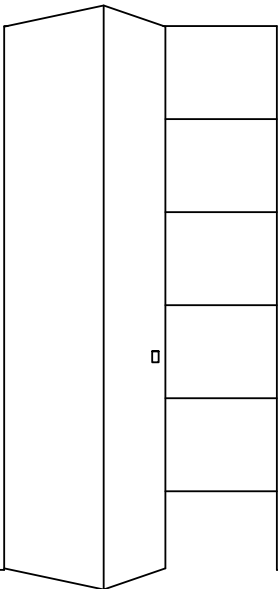

Barn

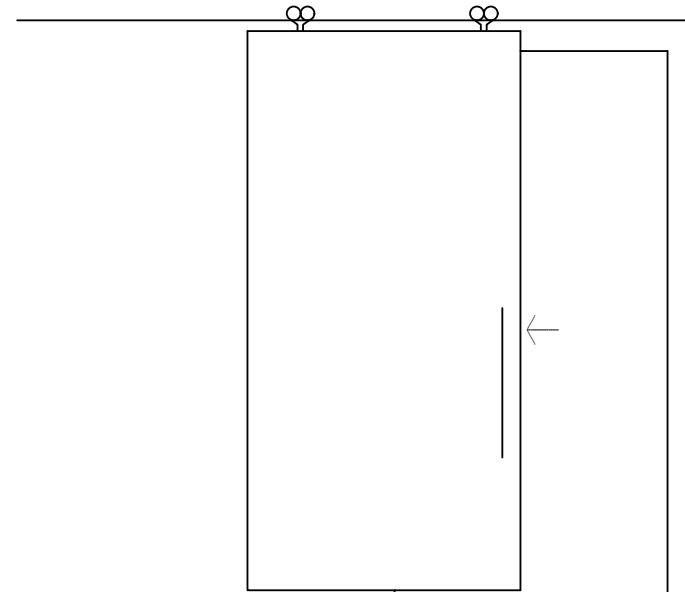

Ghost

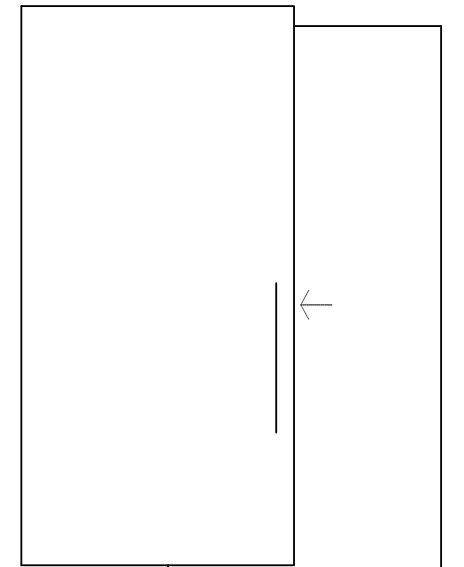



# Finishes

DAYORIS offers a wide variety of finishes for Modern Interior Doors. High end materials can be customized to fit individual preferences and requirements. Our selections feature primed, high-end Italian laminates, wood veneers, and matte lacquer finishes.

- Primed (Paint grade finish)
- Laminated Finishes
- Matte Lacquer



Color match available

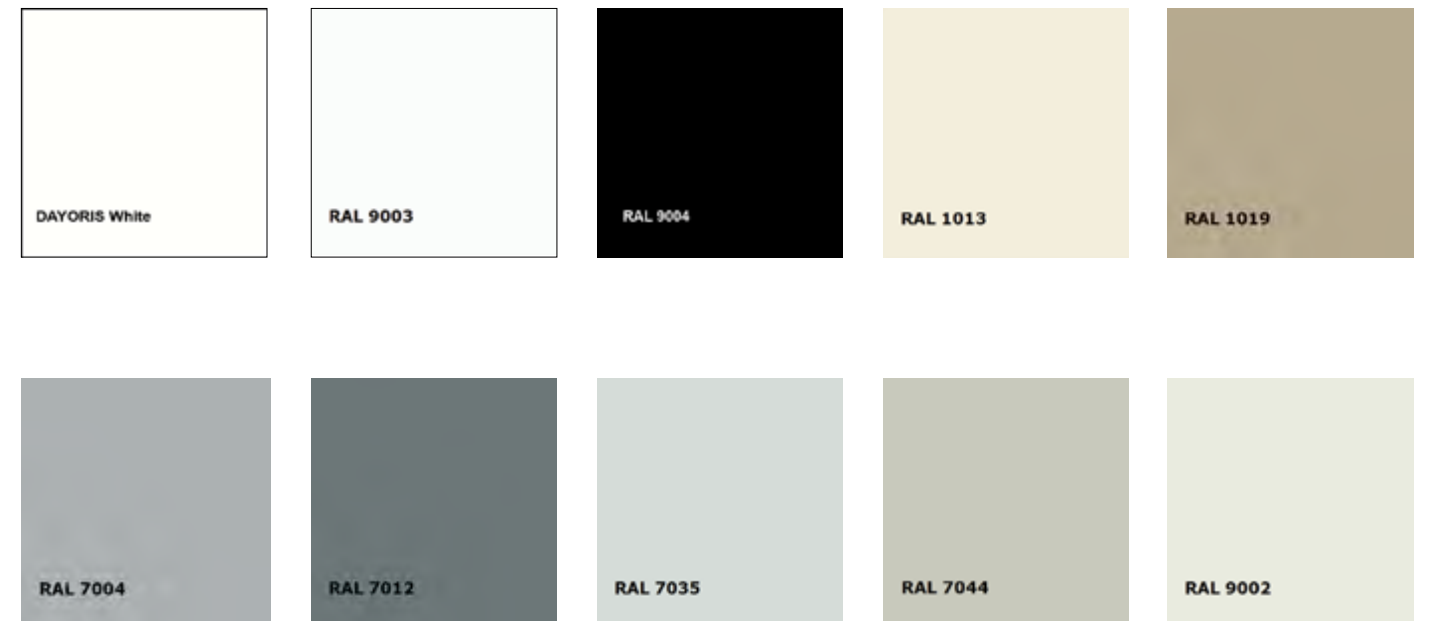

- Wood Veneers (Optional wire brush texture, Custom stain and lacquer)

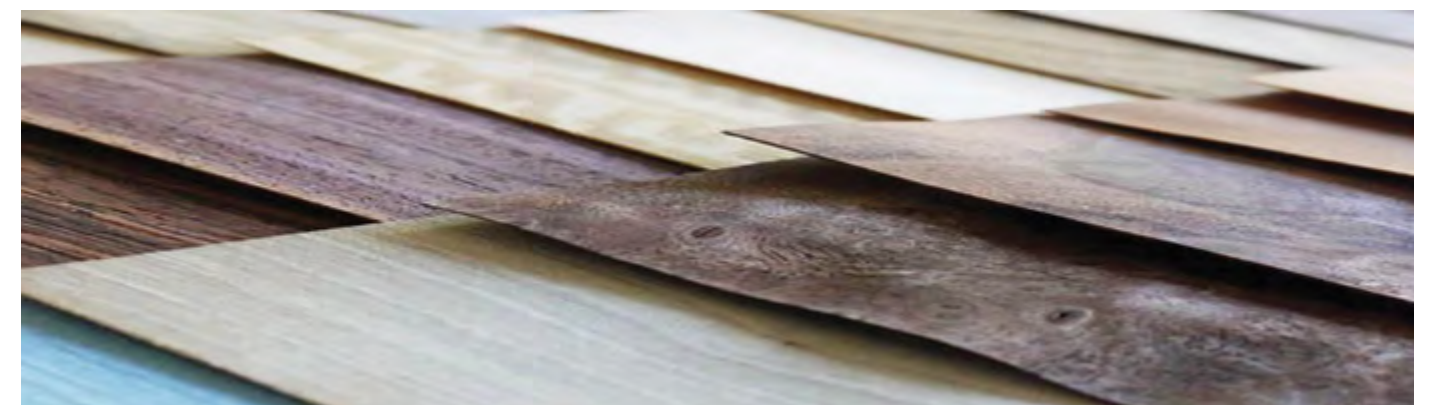





Diamon

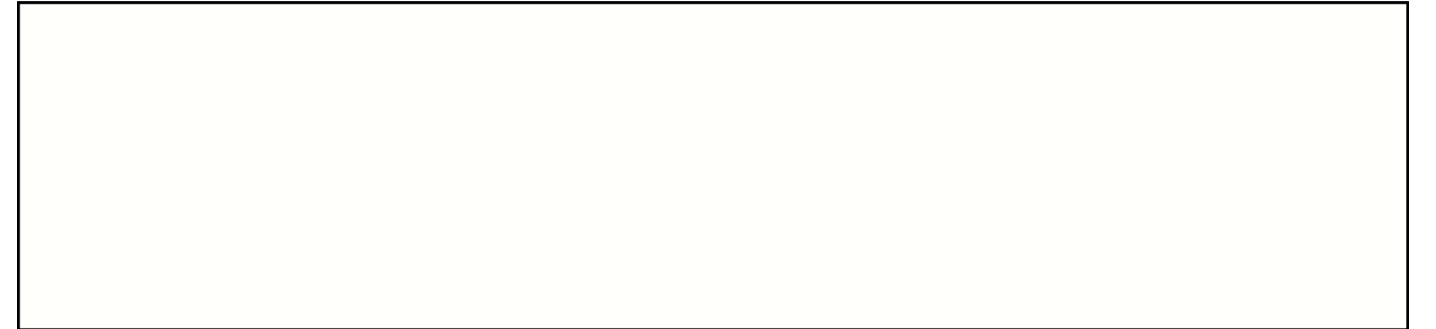

White Matte



Vernice



Natur

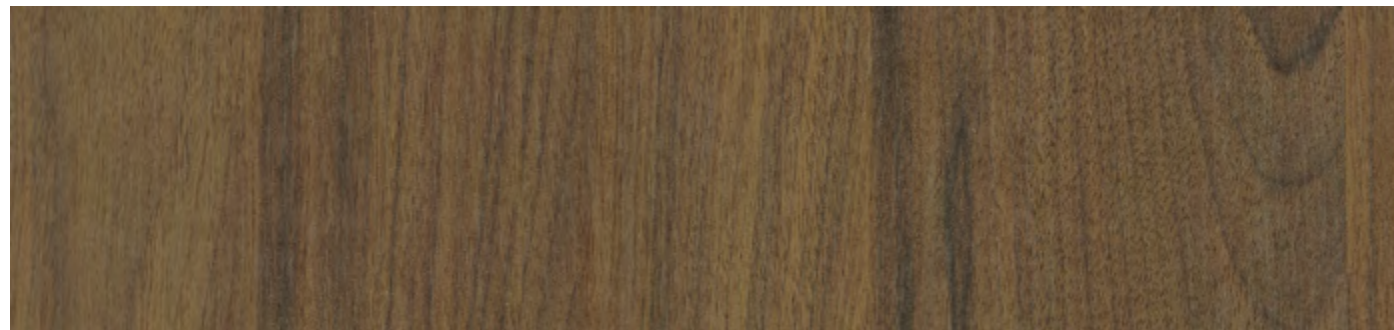

Norey

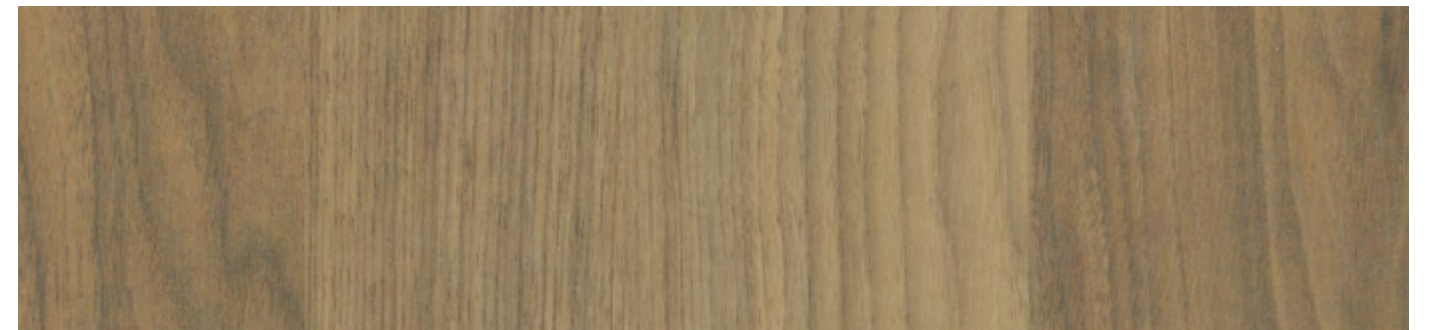

Nogal Siena



Cherry/ Quercia

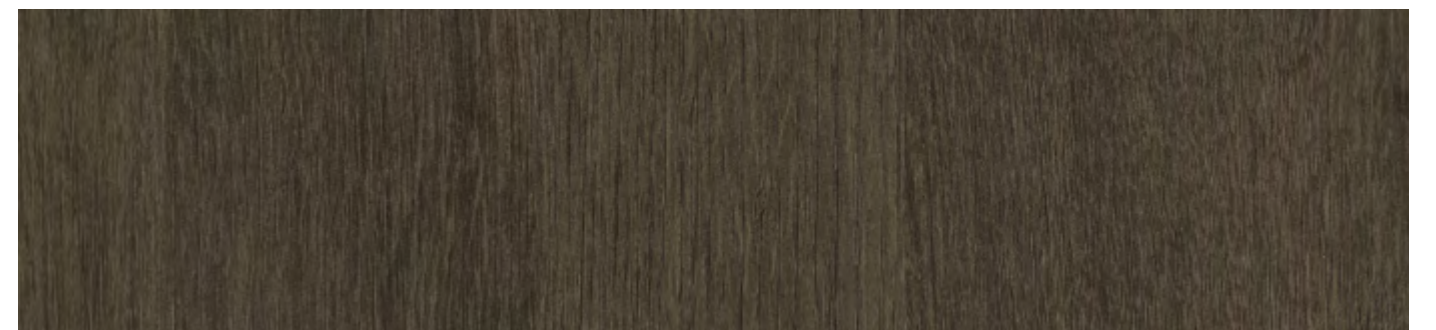

Roble Azabache







Rovere Ljubiana Tenue - 1340



Noce - 1100

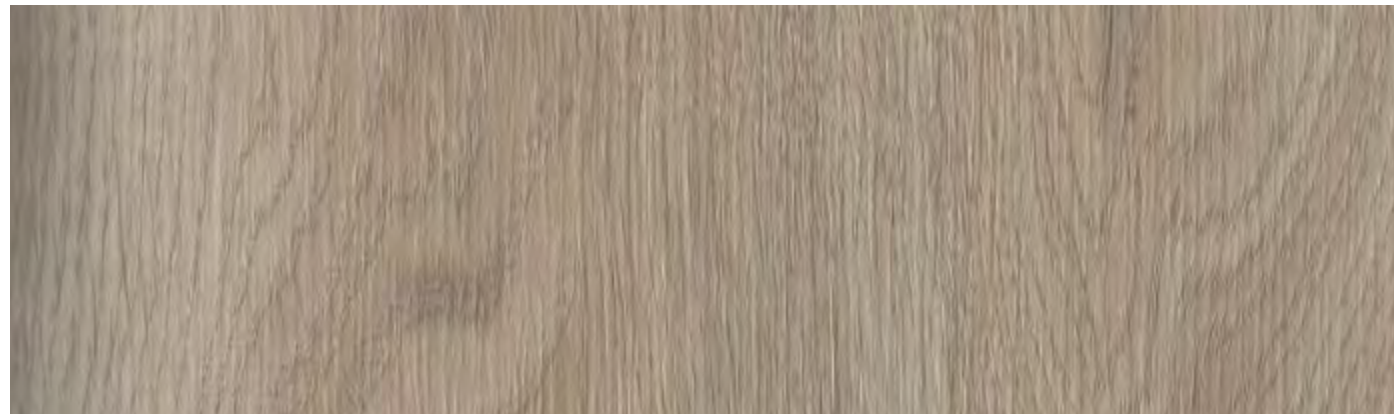

Rovere Arena - 1341



Noce Grigio Argentato - 1124

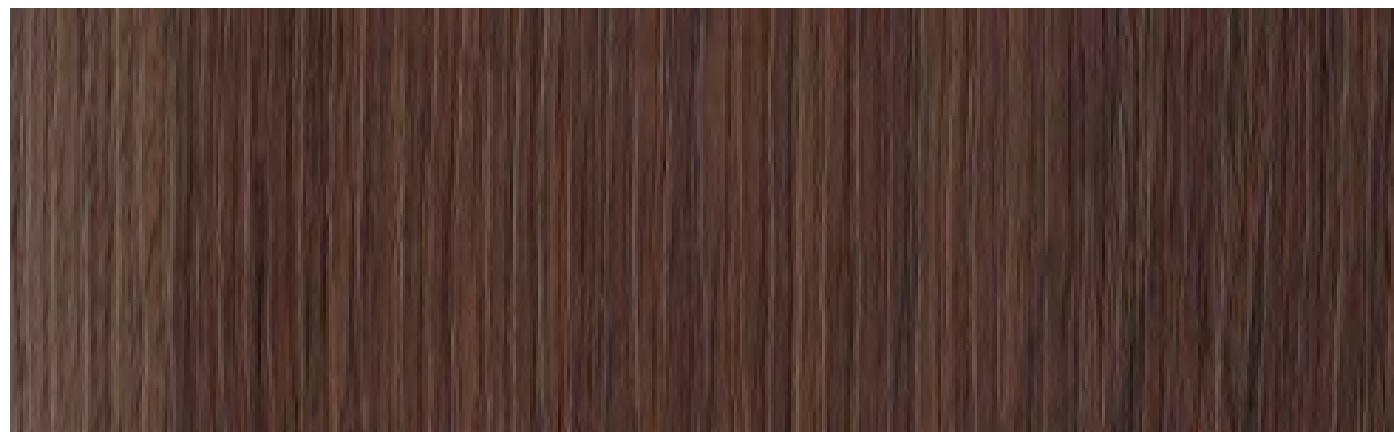

Rovere Navona - 1327



Rovere Cenere - 1326





# - Laminated Suncrest - Domestic



# - Optional Upgrades





# Hardware Included



Round Satin



Square Satin



Round Polished



Square Polished



Flat Round Satin



Twist Satin



Flat Round Polished



Twist Polished



\* Round Black



\* Square Black

\* Optional Upgrades

# - Custom Options

DAYORIS provides personalized options for individuals seeking an added level of customization, luxury, and elegance. Through a partnership with Fimet Handles, you have the opportunity to select from its designs, and DAYORIS will bring your vision to life.



## Magnetic Lock

If another Hardware is specified, the magnetic lock is compatible with all major European brands ( Vali & Vali, Olivari, Colombo, FSB...)





# Black Package

## Optional Upgrade:

- Black Hinges
- Black Aluminum Profile
- Black Mortise Lock and Handles

